

Models ST / ST-B

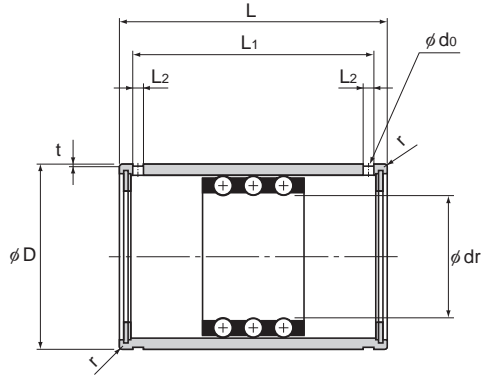

Model ST
(For light load)

Model No.	Maximum stroke	Inscribed bore diameter		Outer diameter	
		dr	Tolerance	D	Tolerance
		ST 6	14	6	+0.018 +0.010
ST 8 ST 8B	24 8	8	+0.022 +0.013	15	
ST 10 ST 10B	30 8	10		+0.027 +0.016	19
ST 12 ST 12B	32 8	12	23		
ST 16 ST 16B	40 16	16	28		
ST 20 ST 20B	54 28	20	+0.033 +0.020	32	0 -0.011
ST 25 ST 25B	54 28	25		37	
ST 30 ST 30B	82 44	30		45	
ST 35 ST 35B	92 54	35	+0.041 +0.025	52	0 -0.013

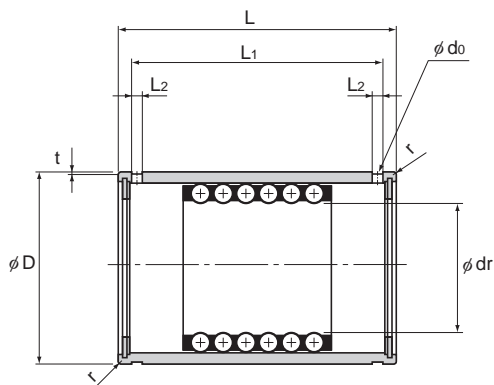

Model ST-B
(For medium load)

Unit: mm

	Length		L ₁	L ₂	t	d _o	r	Basic dynamic load rating	Basic static load rating	Mass
	L	Tolerance						C kN	C ₀ kN	g
	19	0 -0.2	13.5	1.1	0.25	—	0.3	0.98	0.23	8
	24		20.1	1.5	0.5	1.5	0.5	0.98 2.06	0.27 0.55	16.4 17.6
	30		25.7	1.5	0.5	1.5	0.5	2.35 4.61	0.62 1.27	31.5 34.5
	32		27.5	1.5	0.5	1.5	0.5	4.02 8.14	1.08 2.25	47 53.5
	37		32.1	1.5	0.5	1.5	0.5	4.02 8.04	1.27 2.65	77 85
	45		39.8	2	0.5	2	0.5	4.12 8.33	1.57 3.24	109 120
	45	0 -0.3	39.8	2	0.5	2	1	4.12 8.14	1.76 3.63	128 142
	65		58.5	2.5	0.5	2.5	1	9.31 18.7	4.12 8.14	240 275
	70		63.5	2.5	0.7	2.5	1.5	9.41 18.7	4.51 9.02	370 410